

INSTALLATION INSTRUCTIONS

HOW TO ADJUST THE DOOR CLOSER



All door closers have adjustment screws somewhere on the main body of the unit, for altering the speed at which the door swings closed and the speed of the last few inches, which is known as the latch.

CAUTION: DO NOT COMPLETELY UNSCREW DOOR CLOSER ADJUSTMENT SCREWS OR YOU MAY DAMAGE THE CLOSER.



FIG 1. ABOVE SHOWS A DOOR CLOSER FITTED TO A DOOR

FIG 2. SHOWS A CLOSE UP OF THE DOOR CLOSER.

In fig. 2 the two flat headed screw heads set into the side of the unit marked 1 and 2 are for adjusting the swing and latch speed of the door (they are not always marked this way on all closers, some are marked S and L, while some are marked showing 90 – 15 degrees which for the speed and 15 – 0 degrees, for the last bit, the latch, but they will always be there somewhere on the body of the unit)

WHEN IT COMES TO ADJUSTING THESE SCREWS, A LITTLE GOES A LONG WAY, EVEN THE SLIGHTEST TURN CAN GREATLY EFFECT THE SWING SPEED / LATCH RATE.

2

- Swing speed adjustment controls how fast the door closes from fully open to within about 5 degrees of closed
- Latching speed adjustment controls how fast the door closes for those last few inches

5

If you are lucky, they will be marked on the closer body as to what they are or there will be a diagram inside the cover. If not, you may have to experiment a little to see which is which. Remember, when it comes to turning door closer adjustment screws, a little goes a long way. Start with no more than 1/8 of a turn. Turn the adjustment screw slowly to assess its effect on either the swing speed or the latch rate and then adjust the appropriate screw accordingly to suit your requirements

Open the door and watch it close. If it closes right the first time, check it 6 or 7 more times. If it closes correctly every time, you're done. If not, make another adjustment, until the closer is doing what you want it to do. When it closes the way you want it to 6 or 7 times in a row, it will probably continue to do so.

8

TROUBLE SHOOTING DOOR CLOSURE PROBLEMS

- If oil is leaking from the door closer, it may need replacement.
- If the door closer is slamming the door, or will not close fully, again the best option may be to replace it.

(Door closers only have a certain life span.)

2

DOORS YOU PULL TO OPEN

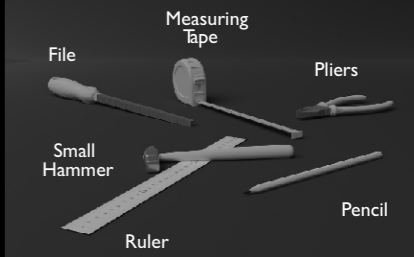
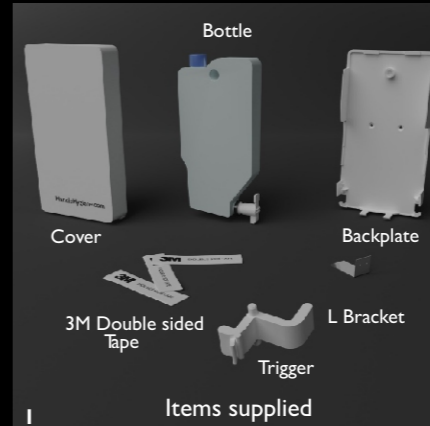

* Note:

150mm may vary on certain doors depending on size but normally 150mm above the handle is ideal

With a light pencil, mark a horizontal line from the edge of the door 150mm above the door handle.

Most door closers have adjustment screws somewhere on the main body of the unit, as seen in Fig. 2 above, however, some door closers have a cover, if you can't see adjustment screws, which will normally be on the door hinge side of the closer, chances are the closer has a cover. Usually the cover is plastic, but it could also be metal. If you see no fasteners holding the cover on, that means the cover is held on by tension. Pull it off. If you do see fasteners, usually you can loosen, but not remove, the fasteners and the cover will slide off. On some closers, particularly Dorma ones, the front of the closer cover slides open to give you access to the adjustment screws.

If you find that there is oil in the cover or oil on or leaking from the closer body, you can stop right now. You need a new door closer. If, however, it is not leaking, you can proceed. Now that you have the cover off, you should be able to see the adjustment screws somewhere on the main body, as in the diagram below.

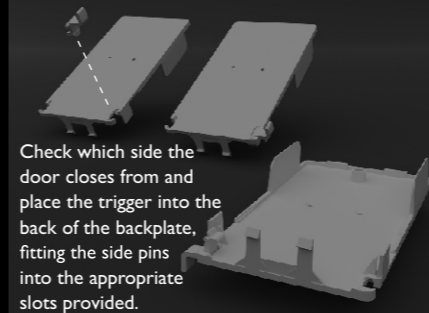
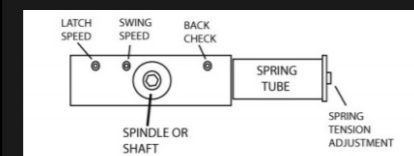

Trigger installation

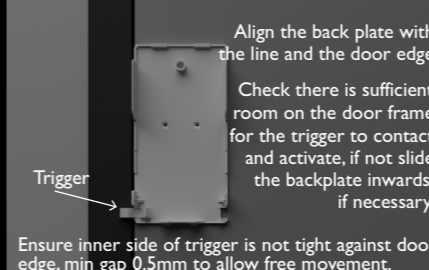

Align the back plate with the line and the door edge

Check there is sufficient room on the door frame for the trigger to contact and activate, if not slide the backplate inwards, if necessary.

Ensure inner side of trigger is not tight against door edge, min gap 0.5mm to allow free movement.

NB: Older door frames with thin or ornate architraves may not have sufficient room for trigger to contact fully, if so create space for trigger on frame somehow, if not unit cannot be fitted.

Mark the spot carefully, remove the tape coverings and stick the back plate firmly to the door

Securing baseplate

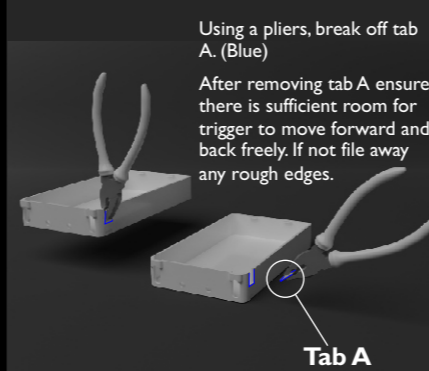

Preparing the cover

Using a pliers, break off tab A. (Blue)

After removing tab A ensure there is sufficient room for trigger to move forward and back freely. If not file away any rough edges.

Tab A

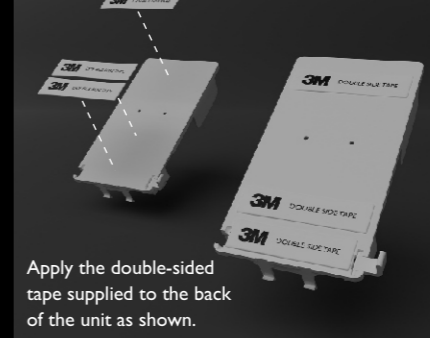

Tape installation



Apply the double-sided tape supplied to the back of the unit as shown.

Further secure backplate to door using L-shaped bracket supplied.

Secure long arm of bracket to backplate using double-sided tape and fix short arm to door edge as shown.

Small pins can be used for securing bracket to door edge if needed.

If required small screws may be used to further secure backplate to door surface. (Screws are not supplied)

Securing baseplate



Positioning the cover

Refer to the Cartridge Installation information to see how to mount the cover onto the backplate



Install the cartridge into the baseplate. For instructions in how to install, please refer to the Cartridge Installation information.

Installing cartridge

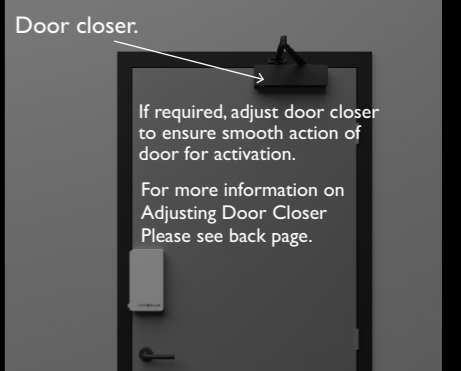

If required, adjust door closer to ensure smooth action of door for activation.

For more information on Adjusting Door Closer Please see back page.

AVOIDING DOOR CLOSURE PROBLEMS

To avoid problems when fitting the Door Handle Sanitising System, it is important to ensure before fitting, that the door closer is functioning properly and that the door is actually opening and closing with a smooth and consistent motion, without any interference from faulty hinges, warped or badly fitted doors etc.

There will be occasions where if the door closer is not functioning properly for whatever reason, it may be necessary to replace the door closer before fitting the Door Unit, if this is not feasible, then perhaps it may be best advised not to fit the system, as it is important to ensure the Door Handle Sanitising System is operating smoothly at all times once fitted.

1

DOORS YOU PUSH TO OPEN

Select the side of the cover to fit the switch and carefully snap off the first tab A (red) with pliers. Then snap off tab B (Blue). It is best to snap the tabs off one at a time.

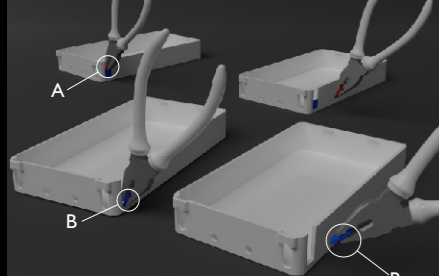

3 Removing the tabs
(Colours shown for identification purposes only)

*** Note:** 150mm may vary on certain doors depending on size but normally 150mm above the handle is ideal

Pull door fully closed and with a light pencil, mark a horizontal line on the door, approximately 150mm above the handle and then a second line in 6mm parallel to the door frame.



6 Marking

Align backplate with the marked lines and stick gently to the door for testing, insert cartridge and attached cover with switch protruding and test by opening and closing the door to check switch is making good contact with the door frame.

If not, adjust the unit to a SUITABLE POSITION, before firmly pressing the unit tight against the door

9 Completing installation

IMPORTANT

It is important the door and the door frame are in line when the door is closed so that the system is operating on a level surface, if the door over-closes it may break the trigger or the unit when it closes, especially if it slams closed for any reason. If the door under closes the trigger will not be able to operate.

Doors Over-closing

If the door over-closes, as in the door goes inside the frame when closed, the unit needs support in behind it to bring it out level with the frame, this may mean using a lath, such as a flat strip of wood or plastic or packing of some description to bring it level with the frame.

1

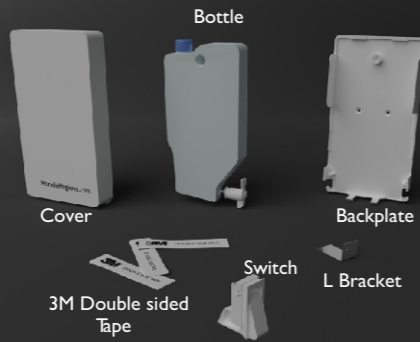

1 Items supplied

File off any edges and ensure base is level, widen gap with file if necessary to allow the switch to slide in and out freely and fully to allow a smooth switch action.

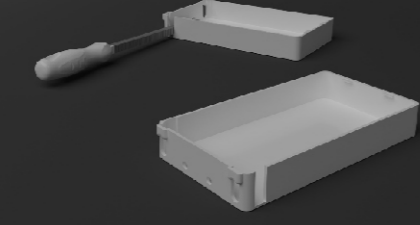

4 Cleaning the opening

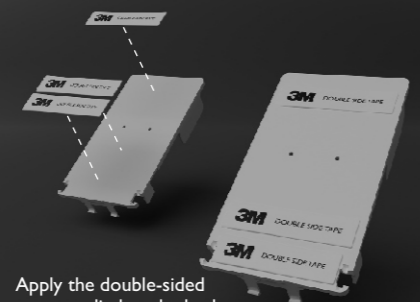

Apply the double-sided tape supplied to the back of the unit as shown.

7 Tape installation

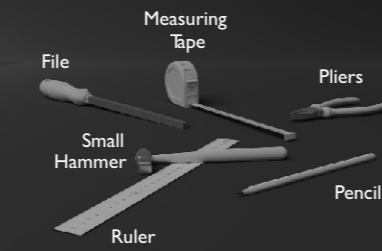

2 Recommended tools for installation
(Not supplied)

Ensure switch is flush with the top edge of the cover and switch is free to rotate back and forth in its sleeve

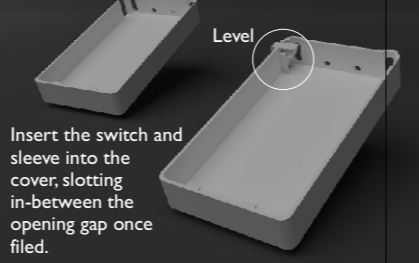

5 Switch installation

Further secure the unit to the door using the L shaped bracket, with the long arm fixed to the backplate and the short arm fixed directly to the door edge.

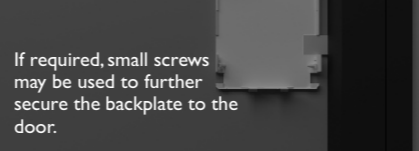

If required, small screws may be used to further secure the backplate to the door.

Screws are not supplied

8 L Shaped Bracket

LONGER NOZZLES FOR DIRECTION

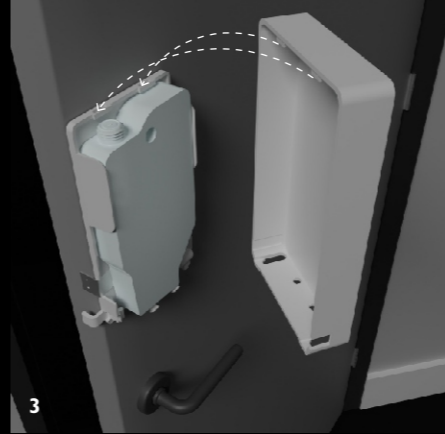

3

To help simplify the installation of the Handle Hygiene system, stainless steel brackets are used to support the unit in position.

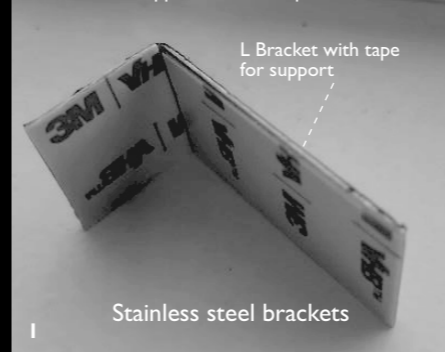

1

Stainless steel brackets

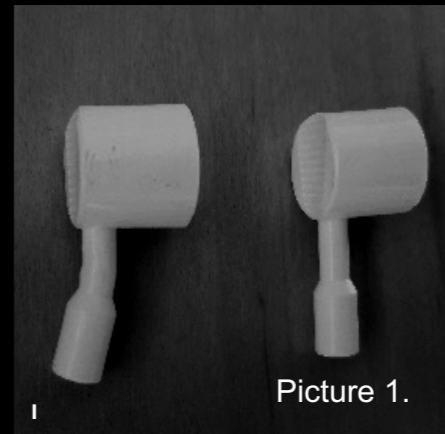

1

Picture 1.

Longer nozzles are now used to get better direction of spray on to the handle, ensuring better coverage. The nozzle can be bent slightly if the handle is not being sprayed fully, see picture 1. The nozzle can be removed and bent by heating the nozzle or by simply using a pliers to bend it 360 degrees, it only needs a slight bend, to create a wider angle of spray.

With the longer nozzle the front cover needs a little manoeuvring with the nozzle protruding out through the hole at the base. see picture 4 figure A. First ensure the nozzle is protruding and then angle the cover in your hand so it can slide up over the back plate and allowing the two pins on the cover drop in to the two receivers on the plate.

2

SIMPLIFYING THE INSTALLATION OF THE HANDLE HYGIENE SYSTEM

These brackets support the units in place and reduce the amount of double sided tape required to fit.

The bracket is stuck to the inside of the door unit to support it, with a second arm that sticks to the edge, if needed, they are further supported using small picture pins on the side, eliminating the need for screws or excess tape

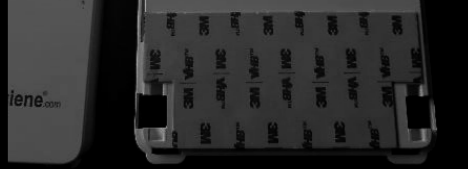

3 66% less tape required

Do's and Don'ts and things to watch out for:

Do: Clean off area for unit thoroughly with an alcohol wipe or similar before sticking.

Don't: Stick unit to door with excessive or old paint covering. Use further means of support.

DOORS NOT FLUSH WITH THE FRAME WHEN IN THE CLOSED POSITION



3 Unit parallel to door edge

CARTRIDGE INSTALLATION

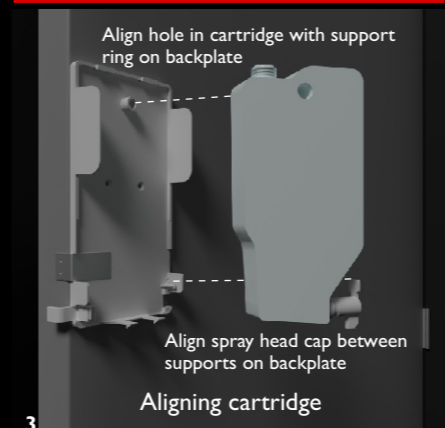

3 Aligning cartridge



1 Opening cover

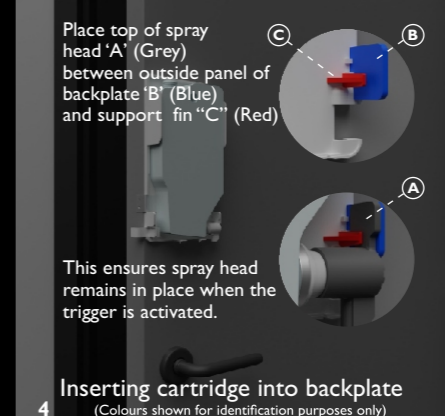

4 Inserting cartridge into backplate
(Colours shown for identification purposes only)

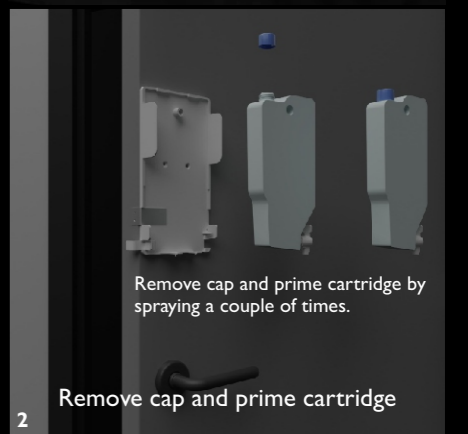

2 Remove cap and prime cartridge

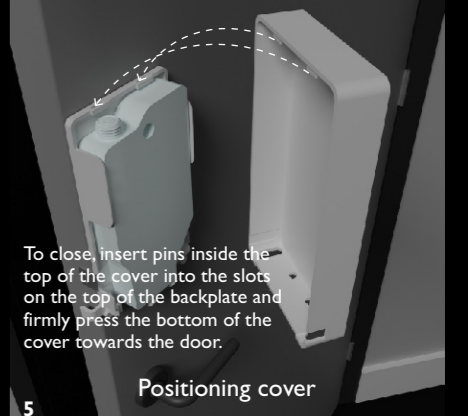

5 Positioning cover